

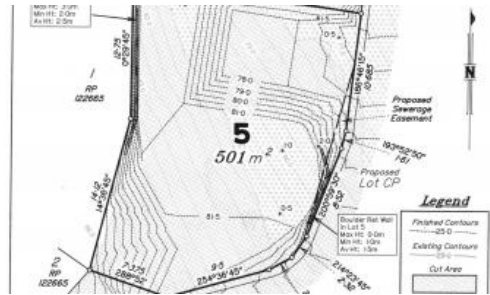

16 Vue Ct, Nambour



## Ready to Build?

Sitting perched up high with views east over Nambour & beyond to Rosemount this vacant titled land is ready to build on. An exclusive 10 lot subdivision that offers a peaceful private lifestyle walking distance to the Nambour Hospital, Train Station, schools & shops. Titles have been issued so building can now commence. Power, water & NBN are all available. Curb & channeling & landscaping all completed. All 10 owners of this boutique estate all pay a yearly body-corp which contributes to the private access road, entrance landscaping & also includes your building insurance. No building covenants in this boutique estate.

An example of a home which suits the block is included in the photo carousel. The 501m2 block (lot 5) is 2 tier which would suit the garage on the lower level with internal stairs to the living.

The above information provided has been furnished to us by the vendor/s. We have not verified whether or not that information is accurate and do not have any belief in one way or the other in its accuracy. We do not accept any responsibility to any person for its accuracy and do no more than pass it on. All interested parties should make and rely upon their own inquiries in order to determine whether or not this information is in fact accurate.

📏 501 m2

<b>Price</b>	Contact agent
<b>Property Type</b>	Residential
<b>Property ID</b>	1600
<b>Land Area</b>	501 m2

### Agent Details

Kate Henderson-Burton - 0458 060 757

### Office Details

Yandina Realty  
2 Stevens St Yandina QLD 4561  
Australia  
07 5446 7699

